

GUARDIAN™ LINK (3)

TRANSMITTER



Medtronic

Contacts:

Africa: Medtronic South Africa and Southern Africa

Office Reception Tel: +27(0) 11 260 9300
Diabetes: 24/7 Helpline: 0800 633 7867
Sub-Sahara 24/7 Helpline: +27(0) 11 260 9490

Albania: Net Electronics Albania
Tel: +355 697070121

Argentina: Corpomedica S.A.
Tel: +(11) 4 814 1333
Medtronic Directo 24/7:
+0800 333 0752

Armenia: Exiol LLC
Tel: +374 98 92 00 11
or +374 94 38 38 52

Australia: Medtronic Australasia Pty. Ltd.
Tel: 1800 668 670

Bangladesh: Sonargaon Healthcare Pvt Ltd.
Mobile: (+91)-9903995417
or (+880)-1714217131

Belarus: Zarga Medica
Tel: +375 29 625 07 77
or +375 44 733 30 99
Helpline: +74995830400

België/Belgique: N.V. Medtronic Belgium S.A.
Tel: 0800-90805

Bosnia and Herzegovina: "Novopharm" d.o.o.
Sarajevo
Tel: +387 33 476 444
Helpline: 0800 222 33
Epsilon Research Intern. d.o.o.
Tel: +387 51 251 037
Helpline: 0800 222 33

Brasil: Medtronic Comercial Ltda.
Tel: +(11) 2182-9200
Medtronic Directo 24/7:
+0800 773 9200

Bulgaria: RSR EOOD
Tel: +359 888993083
Helpline: +359 884504344

Canada: Medtronic Canada ULC
Tel: 1-800-284-4416 (toll free/sans-frais)

Chile: Medtronic Chile
Tel: +(9) 66 29 7126
Medtronic Directo 24/7:
+1 230 020 9750
Medtronic Directo 24/7 (From Santiago):
+(2) 595 2942

China: Medtronic (Shanghai) Management Co., Ltd.
Landline: +86 800-820-1981
Mobile Phone: +86 400-820-1981
Calling from outside China: +86 400-820-1981

Colombia: Medtronic Latin America Inc. Sucursal Colombia
Tel: +(1) 742 7300
Medtronic Directo 24/7 (Landline):
+01 800 710 2170
Medtronic Directo 24/7 (Cellular):
+1 381 4902

Croatia: Mediligo d.o.o.
Tel: +385 1 6454 295
Helpline: +385 1 4881144
Medtronic Adriatic d.o.o.
Helpline: +385 1 4881120

Danmark: Medtronic Danmark A/S
Tel: +45 32 48 18 00

Deutschland: Medtronic GmbH
Geschäftsbereich Diabetes
Telefon: +49 2159 8149-370
Telefax: +49 2159 8149-110
24-Stdn-Hotline: 0800 6464633

Eire: Accu-Science LTD.
Tel: +353 45 433000

España: Medtronic Ibérica S.A.
Tel: +34 91 625 05 42
Fax: +34 91 625 03 90
24 horas: +34 900 120 330

Estonia: AB Medical Group Estonia Ltd
Tel: +372 6552310
Helpline: +372 5140694

Europe: Medtronic Europe S.A. Europe, Middle East and Africa HQ
Tel: +41 (0) 21-802-7000

France: Medtronic France S.A.S.
Tel: +33 (0) 1 55 38 17 00

Hellas: Medtronic Hellas S.A.
Tel: +30 210677-9099

Hong Kong: Medtronic International Ltd.
Tel: +852 2919-1300
To order supplies:
+852 2919-1322
24-hour helpline: +852 2919-6441

India: India Medtronic Pvt. Ltd.
Tel: (+91)-80-22112245 / 32972359
Mobile: (+91)-9611633007
Patient Care Helpline:
1800 209 6777

Indonesia: Medtronic International Ltd.
Tel: +65 6436 5090
or +65 6436 5000

Israel: Medtronic
Tel. (orders):
+9729972440, option 3 + option 1
Tel. (product support):
+9729972440, option 2
Helpline (17:00 – 08:00
daily/weekends – Israel time):
1-800-611-888

Italia: Medtronic Italia S.p.A.
Tel: +39 02 24137 261
Fax: +39 02 24138 210
Servizio assistenza tecnica:
N° verde: 800 60 11 22

Japan: Medtronic Japan Co. Ltd.
Tel: +81-3-6776-0019
24 Hr. Support Line: 0120-56-32-56

Kazakhstan: Medtronic BV in Kazakhstan
Tel: +7 727 311 05 80 (Almaty)
Tel: +7 717 224 48 11 (Astana)
Круглосуточная линия поддержки:
8 800 080 5001

Kosovo: Yess Pharma
Tel: +377 44 999 900
Helpline: +37745888388

Latin America: Medtronic, Inc.
Tel: 1(305) 500-9328
Fax: 1(786) 709-4244

Latvija: RAL SIA
Tel: +371 67316372
Helpline (9am to 6pm):
+371 29611419

Lithuania: Monameda UAB
Tel: +370 68405322
Helpline: +370 68494254

Macedonia: Alkaloid Kons Dooel
Tel: +389 23204438

Magyarország: Medtronic Hungária Kft.
Tel: +36 1 889 0688

Malaysia: Medtronic International Ltd.
Tel: +603 7946 9000

Middle East and North Africa: Regional Office
Tel: +961-1-370 670

Montenegro: Glosarij d.o.o.
Tel: +382 20642495

México: Medtronic Servicios S. de R. L. de C.V.
Tel (México DF): +(11) 029 058
Tel (Interior): +01 800 000 7867
Medtronic Directo 24/7 (from México DF):
+(55) 36 869 787
Medtronic Directo 24/7:
+01 800 681 1845

Nederland, Luxembourg: Medtronic B.V.
Tel: +31 (0) 45-566-8291
Gratis: 0800-3422338

New Zealand: Medica Pacifica
Phone: 64 9 414 0318
Free Phone: 0800 106 100

Norge: Medtronic Norge A/S
Tel: +47 67 10 32 00
Fax: +47 67 10 32 10

Philippines: Medtronic International Ltd.

Tel: +65 6436 5090

or +65 6436 5000

Россия: ООО «Медтроник»

Tel: +7 495 580 73 77

Круглосуточная линия поддержки:
8 800 200 76 36

Polska: Medtronic Poland Sp. z o.o.

Tel: +48 22 465 6934

Portugal: Medtronic Portugal Lda

Tel: +351 21 7245100

Fax: +351 21 7245199

Puerto Rico: Medtronic Puerto Rico

Tel: 787-753-5270

Republic of Korea: Medtronic Korea, Co., Ltd.

Tel: +82.2.3404.3600

Romania: Medtronic Romania S.R.L

Tel: +40372188017

Helpline: +40 726677171

Schweiz: Medtronic (Schweiz) AG

Tel: +41 (0)31 868 0160

24-Stunden-Hotline: 0800 633333

Fax Allgemein: +41 (0)318680199

Serbia: Epsilon Research International d.o.o.

Tel: +381 113115554

Medtronic Serbia D.o.o

Helpline: +381 112095900

Singapore: Medtronic International Ltd.

Tel: +65 6436 5090

or +65 6436 5000

Slovenija: Zaloker & Zaloker d.o.o.

Tel: +386 1 542 51 11

24-urna tehnična pomoč:
+386 51316560

Slovenská republika: Medtronic Slovakia, s.r.o.

Tel: +421 26820 6942

HelpLine: +421 26820 6986

Sri Lanka: Swiss Biogenics Ltd.

Mobile: (+91)-9003077499

or (+94)-777256760

Suomi: Medtronic Finland Oy

Tel: +358 20 7281 200

Help line: +358 400 100 313

Sverige: Medtronic AB

Tel: +46 8 568 585 20

Fax: +46 8 568 585 11

Taiwan: Medtronic (Taiwan) Ltd.

Tel: 02-21836000

Toll free: +886-800-005285

Thailand: Medtronic (Thailand) Ltd.

Tel: +662 232 7400

Türkiye: Medtronic Medikal Teknoloji

Ticaret Ltd. Sirketi.

Tel: +90 216 4694330

USA: Medtronic Diabetes Global Headquarters

24-Hour Technical Support: +1-800-646-4633

To order supplies: +1-800-843-6687

Ukraine: Med Ek Service TOV

Tel: +380 50 3311898

or +380 50 4344346

Лінія цілодобової підтримки:
0 800 508 300

United Kingdom: Medtronic Ltd.

Tel: +44 1923-205167

Österreich: Medtronic Österreich GmbH

Tel: +43 (0) 1 240 44-0

24 – Stunden – Hotline: 0820 820 190

Česká republika: Medtronic Czechia s.r.o.

Tel: +420 233 059 111

Non-stop helpLine (24/7):

+420 233 059 059

Zákaznický servis (8:00 - 17:00):

+420 233 059 950

The Guardian™ Link (3) transmitter with Bluetooth™* wireless technology is a component of the continuous glucose monitoring (CGM) system for a MiniMed™ insulin pump with smart device connectivity. The transmitter is compatible only with the Guardian™ Sensor (3) glucose sensor. The transmitter collects data from the sensor. The transmitter then wirelessly sends the data to the insulin pump.

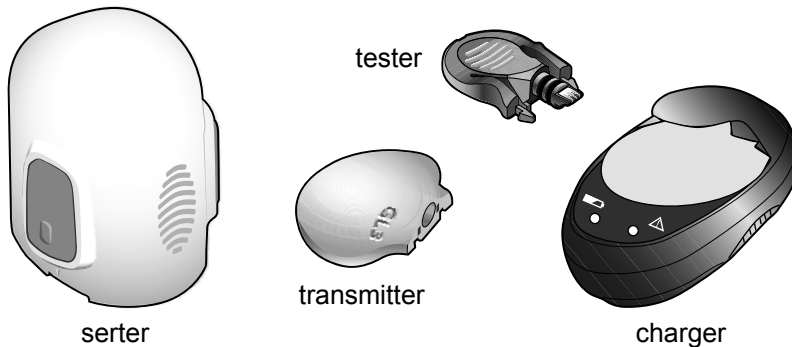

Guardian™ Link (3) transmitter kit components

A complete transmitter kit includes the following components:

- Guardian™ Link (3) transmitter (MMT-7911)
- Two testers (MMT-7736L)
- Charger (MMT-7715)
- One-pressserter (MMT-7512)

Indications for use

The Guardian™ Link (3) transmitter (MMT-7911) is intended for use with MiniMed™ 770G System. The transmitter powers the glucose sensor, collects and calculates sensor data, and sends the data to a compatible MiniMed™ insulin pump system with smart device connectivity for the management of diabetes mellitus. The transmitter is intended for single-patient, multi-use.

Contraindications

None known.

Warnings

- Do not use the transmitter adjacent to other electrical equipment that may cause interference with the normal system operation. Other electrical equipment that may compromise normal system operation has been contraindicated. For more information on electrical equipment that may compromise normal system operation, see *Exposure to magnetic fields and radiation, on page 2*.
- Always refer to the sensor user guide for all precautions, warnings, and instructions relating to the sensor. Not referring to the sensor user guide can result in serious injury or damage to the sensor.
- Do not allow children to put small parts in their mouth. This product poses a choking hazard for young children.
- Do not change or modify the device unless expressly approved by Medtronic Diabetes. Modifying the device can cause serious injury, interfere with your ability to operate the device, and void your warranty.
- Do not use the tester if it comes in contact with blood. Touching blood can cause infection. Dispose of the tester according to the local regulations for medical waste disposal, or contact your healthcare professional for disposal information.
- Bleeding may occur after inserting the sensor. Always make sure that the site is not bleeding before connecting the transmitter to the sensor. Blood can get into the transmitter connector and damage the device. Discard the device if damaged. If bleeding occurs, apply steady pressure with a sterile gauze or clean cloth at the insertion site until bleeding stops. After bleeding stops, connect the transmitter to the sensor.
- Contact 24-Hour Technical Support if you experience any adverse reactions associated with the transmitter or sensor. Adverse reactions can cause serious injury.
- Do not discard the transmitter in a medical waste container or expose it to extreme heat. The transmitter contains a battery that may ignite and result in serious injury.

Exposure to magnetic fields and radiation

- Do not expose your transmitter to Magnetic Resonance Imaging (MRI) equipment, diathermy devices, or other devices that generate strong magnetic fields (for example, x-ray, CT scan, or other types of radiation). Exposure to a strong magnetic field has not been evaluated and can cause the device to malfunction, result in serious injury, or be unsafe. If your transmitter is exposed to a strong magnetic field, discontinue use and contact 24-Hour Technical Support for further assistance.

- Always remove your sensor and transmitter before entering a room that has x-ray, MRI, diathermy, or CT scan equipment. Exposure to a strong magnetic field has not been evaluated and can cause the device to malfunction, result in serious injury, or be unsafe. If your sensor or transmitter is exposed to a strong magnetic field, discontinue use and contact 24-Hour Technical Support for further assistance.
- Always carry the Medical emergency card provided with your device when you are traveling. The Medical emergency card provides critical information about airport security systems and using your transmitter safely on an airplane that can help you and others. Not following the guidance on the Medical emergency card could result in serious injury.

Precautions

- Do not attempt to use the Guardian™ Link (3) transmitter (MMT-7911) with a MiniMed™ insulin pump without smart device connectivity. Only a MiniMed™ insulin pump with smart device connectivity can communicate with the Guardian™ Link (3) transmitter (MMT-7911).
- Only use the Guardian™ Sensor (3) glucose sensor (MMT-7020) with the transmitter. Do not use any other sensor. Other sensors are not intended for use with the transmitter and will damage the transmitter and the sensor.
- Only use the green colored tester (MMT-7736L) with the transmitter. Pockets on the transmitter are visible when connected to the tester. Do not use any other test plug. Other test plugs are not intended for use with the transmitter and will damage the transmitter and the tester.

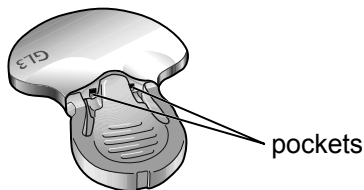

- Always use the tester when cleaning the transmitter. Do not use any other test plug with the transmitter. Use of another test plug can allow water to get into the transmitter or can prevent proper cleaning. Water can damage the transmitter.
- Do not twist the tester or sensor while attached to the transmitter. Twisting the tester or sensor will damage the transmitter.
- Do not allow the tester to come in contact with any liquid when not connected to the transmitter. A wet tester can damage the transmitter.

- Do not allow the transmitter to come in contact with any liquid when not connected to a sensor or to the tester. Moisture will damage the transmitter and a wet transmitter can damage the sensor.
- Do not clean the O-rings on the tester with any substances. Cleaning the O-rings can damage the tester.

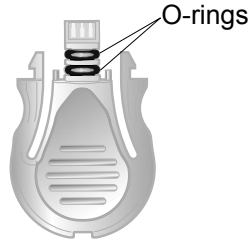

Radio Frequency (RF) communication

This device complies with the United States Federal Communications Commission (FCC) and international standards for electromagnetic compatibility. This device complies with Part 15 of the FCC Rules. Operation is subject to two conditions: (1) This device may not cause harmful interference, and (2) this device must accept any interference received, including interference that may cause undesired operation.

This device has been tested and found to comply with the limits for a Class B digital device, pursuant to Part 15 of the FCC rules. These limits are designed to provide reasonable protection against harmful interference in a residential installation. This device generates, uses, and can radiate radio frequency energy and, if not installed and used in accordance with the instructions, may cause harmful interference to radio communications. However, even when installed and used in accordance with the instructions, no particular installation can guarantee that harmful interference will not occur. If this device does cause harmful interference to radio or television reception, which can be determined by turning the device off and on, the user is encouraged to try to correct the interference by one or more of the following measures:

- Reorient or relocate the receiving antenna.
- Increase the separation between the device and the receiver.
- Decrease the distance between the transmitter and the insulin pump to 6 feet (1.8 meters) or less.
- Increase the separation between the transmitter and the equipment that is receiving or emitting interference.

Note: Harmful interference is defined by the FCC as follows. Any emission, radiation or induction that endangers the functioning of a radio navigation service or of other safety services or seriously degrades, obstructs or repeatedly interrupts a radio communications service operating in accordance with FCC rules.

Changes or modifications made to this equipment not expressly approved by Medtronic Diabetes could void the user's authority to operate the equipment.

IEC 60601-1-2:2014, 4th Edition; Special EMC Precautions for Medical Electrical Equipment

- 1 Special Precautions regarding Electromagnetic Compatibility (EMC): This body worn device is intended to be operated within a reasonable residential, domestic, public or work environment where common levels of radiated "E" (V/m) or "H" fields (A/m) exist, such as cellular phones, Wi-Fi™*, Bluetooth™* wireless technology, electric can openers, microwave and induction ovens. This device generates, uses, and can radiate radio frequency energy and, if not installed and used in accordance with the provided instructions, may cause harmful interference to radio communications.
- 2 Portable and mobile RF communications equipment can affect medical electrical equipment. If you encounter RF interference from a mobile or stationary RF transmitter, move away from the RF transmitter that is causing the interference.
- 3 Be careful when you use your transmitter closer than 12 in (30 cm) to portable radio frequency (RF) equipment or electrical equipment. If you must use your transmitter next to portable RF equipment or electrical equipment, observe the transmitter to verify correct system operation. Degradation of the performance of the transmitter could result.

Assistance

Medtronic MiniMed provides 24-Hour Technical Support for assistance. When calling the HelpLine, please have the serial number of your device available. The serial number and 24-Hour Technical Support phone number are listed on the back of your device.

Please contact 24-Hour Technical Support if you need a copy of a MiniMed™ system user guide.

Department	Telephone number
24-Hour Technical Support (calls within the United States)	800 646 4633

Department	Telephone number
24-Hour Technical Support (calls outside the United States)	+1 818 576 5555
Website	www.medtronicdiabetes.com

Preparing your transmitter

The transmitter contains a non-replaceable, rechargeable battery that you can recharge as needed with the charger. The transmitter needs to be charged before you use it. The charger has a green light that shows the charging status and a red light that communicates any problems during charging. If you see a red light, see *Troubleshooting, on page 15*. The charger needs one AAA alkaline battery.

Note: *If the battery is installed incorrectly or is low, the charger will not work. Repeat the battery installation steps using a new battery.*

Installing a battery in the charger

To install a battery in the charger:

- 1 Push the battery cover in and slide it off (as shown in the image in step 3).
- 2 Insert a new AAA alkaline battery. Make sure the + and - symbols on the battery align with these same symbols shown on the charger.
- 3 Slide the cover back on the charger until it clicks into place.

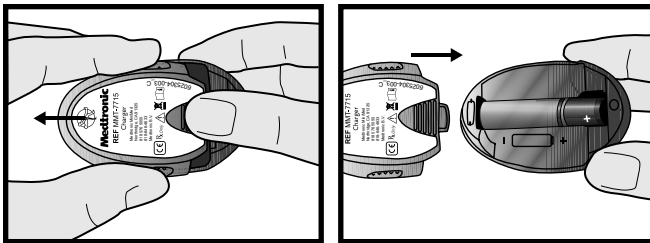

Charging the transmitter

CAUTION: Always charge the transmitter before inserting your sensor. A depleted transmitter does not function. A fully charged transmitter works at least seven days without recharging. A depleted transmitter can take up to two hours to recharge.

CAUTION: Do not store the transmitter on the charger for more than 60 days. Disconnect and reconnect to the charger to re-charge before use. If the transmitter is left on the charger for more than 60 days, the transmitter battery will be permanently damaged.

To charge the transmitter:

- 1 Push the transmitter and the charger together to connect the transmitter to the charger.
- 2 Within 10 seconds after the transmitter is connected, a green light on the charger will flash for one to two seconds as the charger powers on. For the rest of the charging time, the green light on the charger will continue to flash in a pattern of four flashes with a pause between the four flashes.
- 3 When charging is complete, the green light on the charger will stay on, without flashing, for 15 to 20 seconds and then turn off.
- 4 After the green charger light turns off, disconnect the transmitter from the charger. The green light on the transmitter starts to flash.

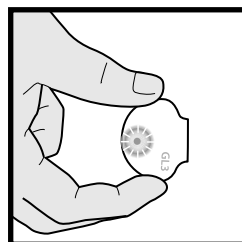
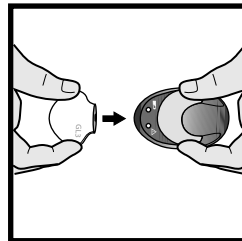

Pairing your transmitter

Always refer to the system user guide for instructions on how to pair your transmitter with your pump. The pump and the transmitter must be paired before data from the sensor can be sent to the pump. The pump and the transmitter are only required to be paired once. There is no need to pair the pump with the transmitter again when you insert a new sensor.

Inserting the sensor

Always refer to your sensor user guide for instructions on how to insert the sensor.

Connecting the transmitter to the sensor

Before proceeding, have your MiniMed™ insulin pump system user guide available.

To connect the transmitter to the sensor:

- 1 After the sensor is inserted, consult your sensor user guide for details on how to apply the required tape before connecting the transmitter.
- 2 Hold the rounded end of the inserted sensor to prevent it from moving during connection.
- 3 Hold the transmitter as shown. Line up the two notches on the transmitter with the side arms of the sensor. The flat side of the transmitter should face the skin.
- 4 Slide the transmitter onto the sensor connector until the sensor arms snap into the notches on the transmitter. If the transmitter is properly connected, and if the sensor has had enough time to become hydrated with the interstitial fluid, the green light on the transmitter will flash 6 times.

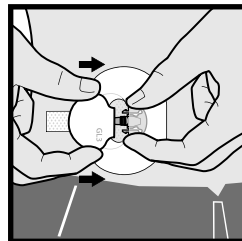

Note: If the transmitter does not flash, see *Troubleshooting*, on page 15.

- 5 When the transmitter light flashes green after connecting to the sensor, use your pump to start the sensor. For more instructions, see your system user guide.
- 6 Attach the adhesive tab of the sensor to the transmitter.
- 7 After the transmitter is connected, consult your sensor user guide for details on how to apply the required tape.
- 8 Follow the instructions that appear on the pump screen or in your system user guide.

Disconnecting the transmitter from the sensor

Before proceeding, have your MiniMed™ insulin pump system user guide available.

To disconnect the transmitter from the sensor:

- 1 Carefully remove any tape from the transmitter and sensor.
- 2 Remove the adhesive tab from the top of the transmitter.
- 3 Hold the transmitter as shown, and pinch the flexible side arms of the sensor between your thumb and forefinger.
- 4 Gently pull the transmitter away from the sensor.
- 5 Follow the instructions that appear on the pump or in your system user guide.

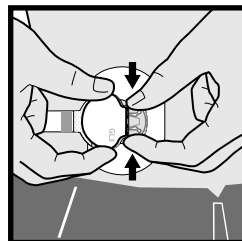

Removing the sensor

Always refer to the sensor user guide for instructions on how to remove the sensor.

Reconnecting the transmitter to a sensor that is already inserted

You can reconnect your transmitter to the sensor you are currently using. Simply connect your transmitter to the sensor that is already inserted. When the pump detects the transmitter, confirm that you want to Reconnect Sensor. It may take a few seconds to establish a connection when reconnecting a sensor. Reattach the adhesive tab of the sensor to the transmitter and reapply any required tape. When you reconnect a sensor, the sensor will go through another warm-up period before you can calibrate it.

Tester

The tester is used to test the transmitter to make sure it is working. The tester is also used as a required component to create a waterproof seal when cleaning the transmitter. Properly connecting the tester to the transmitter ensures that fluids do not come in contact with the connector pins inside the transmitter. Fluids can cause connector pins to corrode and affect the performance of the transmitter.

Do not twist the tester while it is attached to the transmitter. This will damage the transmitter.

The tester can be used for one year. If you continue to use the tester for more than one year, the connector pins inside the transmitter could be damaged, because the tester cannot continue to provide a waterproof seal. For instructions on how to check the connector pins, see *Inspecting the transmitter connector pins, on page 10*.

CAUTION: Only use the green colored tester (MMT-7736L) with the transmitter. Pockets on the transmitter are visible when connected to the tester. Do not use any other test plug. Other test plugs are not intended for use with the transmitter and will damage the transmitter and the tester.

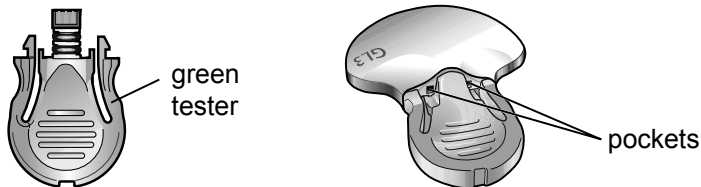

Inspecting the transmitter connector pins

This image is an example of how the connector pins should look.

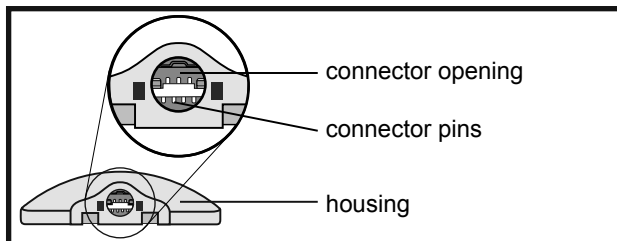

Look inside the connector opening of the transmitter to make sure that the connector pins are not damaged or corroded. If the connector pins are damaged or corroded, the transmitter cannot communicate with the charger or the pump. Contact 24-Hour Technical Support. It may be time to replace your transmitter.

Also look for moisture inside the connector opening. If you see any moisture, allow the transmitter to dry for at least one hour. Moisture inside the connector opening could cause the transmitter to not work properly and could cause corrosion and damage over time.

Connecting the tester for testing or cleaning

Before proceeding, have your MiniMed™ insulin pump system user guide available.

To connect the tester:

- 1 Hold the transmitter and the tester as shown. Line up the flat side of the tester with the flat side of the transmitter.
- 2 Push the tester into the transmitter until the flexible side arms of the tester click into the notches on both sides of the transmitter. When properly connected, the green light on the transmitter flashes 6 times.
- 3 To test the transmitter, check the sensor icon on the pump to ensure that the transmitter is sending a signal (see your system user guide).
- 4 To clean the transmitter, see *Cleaning the transmitter*, on page 11.
- 5 After testing or cleaning, disconnect the tester from the transmitter.

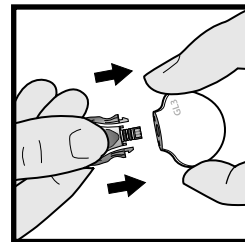

Disconnecting the tester

To disconnect the tester:

- 1 Hold the transmitter body as shown and pinch the side arms of the tester.
- 2 With the tester arms pinched, gently pull the transmitter away from the tester.

Note: To save transmitter battery life, do NOT leave the tester connected after cleaning or testing.

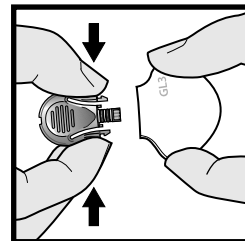

Cleaning the transmitter

The transmitter is a single-patient use device and not intended for multi-patient use.

WARNING: Do not discard the transmitter in a medical waste container or expose it to extreme heat. The transmitter contains a battery that may ignite and result in serious injury.

Note: The tester is a required component for cleaning the transmitter. For details, see *Tester*, on page 9.

CAUTION: Do not use automated washer-disinfector to clean or disinfect the device. Using automated washer-disinfector to clean or disinfect the device will cause damage to the transmitter.

Always clean the transmitter after each use.

To clean the transmitter, you need the following materials:

- mild liquid soap
- soft-bristled toddler toothbrush
- container
- clean, lint-free dry cloths

Use life

The transmitter can be cleaned up to 122 times or for one year, whichever comes first. Discard the transmitter at this point. If you continue to use the transmitter beyond 122 times or one year, the cleaning process may damage the device.

Contact Medtronic to order a new transmitter.

WARNING: Do not use the device if you see any cracking, flaking, or damage to the housing. Cracking, flaking, or damage to the housing are signs of deterioration. Deterioration of the housing can affect the ability to properly clean the transmitter and result in serious injury. Call 24-Hour Technical Support and discard the device according to local regulations for battery disposal (non-incineration), or contact your healthcare professional for disposal information.

To clean the transmitter:

- 1 Wash your hands thoroughly.
- 2 Attach the tester to the transmitter to create a waterproof seal.

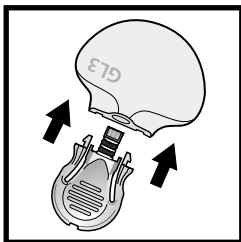

- 3 If there is adhesive residue on the transmitter, see *Removing adhesive residue*, on page 14.
- 4 Rinse the transmitter under room temperature tap water for at least one minute, and until visibly clean. Make sure all hard-to-reach areas are rinsed completely.

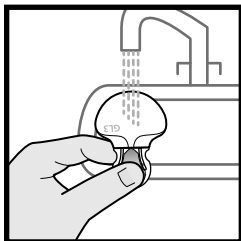

- 5 Prepare a mild liquid soap solution using 1 teaspoon (5 milliliters) of mild liquid soap per 1 gallon (3.8 liters) of room temperature tap water.

- 6 With the tester still attached, submerge the transmitter in the mild liquid soap solution and soak for one minute.

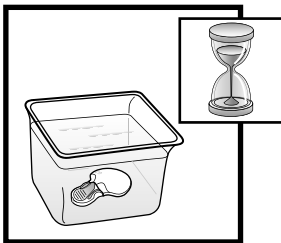

- 7 Holding the tester, brush the entire surface of the transmitter using a soft-bristled toddler toothbrush. Make sure to brush all hard-to-reach areas until visibly clean.



- 8 Rinse the transmitter under running room temperature tap water for at least one minute, and until all visible liquid soap is gone.

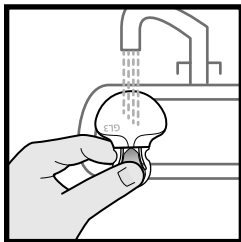

9 Dry the transmitter and tester with a clean, dry cloth.

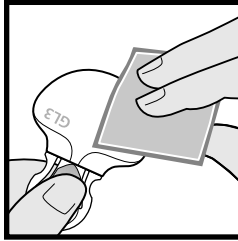

10 Place the transmitter and tester on a clean, dry cloth and air dry them completely.

11 Disconnect the tester from the transmitter by gently squeezing the arms of the tester.

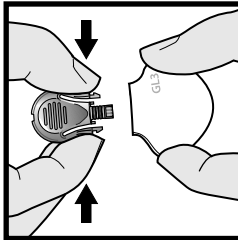

Removing adhesive residue

You may need to perform this procedure if there is adhesive residue present on the transmitter. If you visually inspect the transmitter and see adhesive residue on it, follow these instructions.

To remove adhesive residue, you need cotton swabs and a medical adhesive remover such as Detachol™*, which is a mineral spirit.

Note: *During testing, Medtronic MiniMed used Detachol™* to remove the adhesive residue from the transmitter.*

To remove adhesive residue:

- 1 Make sure the tester is attached to the transmitter.
- 2 Soak a cotton swab in the medical adhesive remover.

- 3 Hold the tester and gently rub the adhesive remover on the transmitter until the residue is removed.

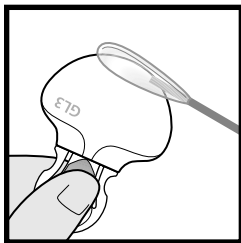

- 4 Continue with the cleaning procedure. See *Cleaning the transmitter*, on page 11 for details.

Bathing and swimming

After the transmitter and sensor are connected, they form a waterproof seal to a depth of 8 feet (2.4 meters) for up to 30 minutes. You can shower and swim without removing them.

Cleaning the charger

This procedure is for general cleaning as required, based on physical appearance.

CAUTION: Do not immerse the charger in water or any other cleaning agent. The charger is not waterproof. Water can damage the charger and cause the device to malfunction.

WARNING: Dispose the charger according to the local regulations for battery disposal, or contact your healthcare professional for disposal information. The charger may ignite upon incineration.

To clean the charger:

- 1 Wash your hands thoroughly.
- 2 Use a damp cloth with mild cleaning solution, such as a dishwashing detergent, to clean any dirt or foreign material from the outside of the charger. Never use organic solvents, such as paint thinner or acetone, to clean the charger.
- 3 Place the charger on a clean, dry cloth and air dry for two to three minutes.

Troubleshooting

The following table contains troubleshooting information for the transmitter, charger, and tester. For more information about troubleshooting, see your system user guide.

Problem	Likely Cause(s)	Resolution
<p>You connected the transmitter to the charger and no lights came on.</p>	<p>The transmitter connector pins are damaged or corroded.</p> <p>Your charger battery has no power or no battery is inserted.</p>	<ol style="list-style-type: none"> 1 Check the transmitter connector pins for damage or corrosion. For more information about your connector pins, see <i>Inspecting the transmitter connector pins, on page 10</i>. If the pins are damaged or corroded, contact 24-Hour Technical Support. It may be time to replace your transmitter. 2 If there is no damage to the connector pins, replace the battery in the charger. For instructions on replacing your charger battery, see <i>Installing a battery in the charger, on page 6</i>.
<p>During charging, the flashing green light on the charger turns off and you see a longer flashing red light on the charger.</p>	<p>Your charger battery is low on power.</p>	<p>Replace the battery in the charger. For instructions on replacing your charger battery, see <i>Installing a battery in the charger, on page 6</i>.</p>
<p>During charging, the flashing green light on the charger turns off and you see a series of quick flashing red lights on the charger for two seconds at a time.</p>	<p>Your transmitter is low on power.</p>	<ol style="list-style-type: none"> 1 Charge the transmitter continuously for one hour. If flashing does not stop, proceed to step 2. 2 Charge the transmitter continuously for eight hours. If flashing does not stop, call 24-Hour Technical Support. It may be time to replace your transmitter.
<p>During charging, a mix of quick and long flashing red lights appear on the charger.</p>	<p>Your charger <i>and</i> your transmitter are low on power.</p>	<ol style="list-style-type: none"> 1 Replace the battery in the charger. For instructions on replacing your charger battery, see <i>Installing a battery in the charger, on page 6</i>. 2 Charge the transmitter continuously for one hour. If the quick flashing red lights do not stop, proceed to step 3. 3 Charge the transmitter continuously for eight hours. If flashing does not stop, call 24-Hour Technical Support. It may be time to replace your transmitter.

Problem	Likely Cause(s)	Resolution
<p>The green light on the transmitter does not flash when you connect it to the sensor.</p>	<p>Your transmitter is not fully connected.</p> <p>Your transmitter is low on power.</p> <p>Your sensor is not properly inserted into your body.</p>	<ol style="list-style-type: none"> 1 Disconnect the transmitter from the sensor. 2 Wait for five seconds and reconnect them. If the green light still does not flash, proceed to step 3. 3 Fully charge the transmitter and connect it to the tester. If the green light still does not flash, see troubleshooting on “The green light on the transmitter does not flash when you connect it to the tester”. If the green light flashes, proceed to step 4. 4 Disconnect the transmitter from the tester, wait at least five seconds, and connect the transmitter to the sensor. If the green light still does not flash, proceed to step 5. 5 The sensor may not be properly inserted into your body. Remove the sensor from your body and insert a new sensor.
<p>The green light on the transmitter does not flash when you connect it to the tester.</p>	<p>Your transmitter is not fully connected.</p> <p>Your transmitter is low on power.</p>	<ol style="list-style-type: none"> 1 Check the connection between the transmitter and the tester. If the green light still does not flash, proceed to step 2. 2 Fully charge the transmitter. 3 Test the transmitter with the tester again. If you still do not see the green light flash, call 24-Hour Technical Support. It may be time to replace your transmitter.
<p>Your transmitter battery does not last for seven days.</p>	<p>Your transmitter is not fully charged when you connect it to the sensor.</p> <p>The transmitter and pump frequently lose wireless connection.</p>	<ol style="list-style-type: none"> 1 Fully charge the transmitter before connecting it to the sensor. If the transmitter battery still does not last for the duration of one sensor use, proceed to step 2. 2 Move away from any equipment that can cause RF interference. For more information on RF interference, see <i>Radio Frequency (RF) communication</i>, on page 4. 3 Make sure your pump and your transmitter are located on the same side of your body to minimize any RF interference. If your fully charged transmitter battery continues to lose power before a full seven days, call 24-Hour Technical Support. It may be time to replace your transmitter.

Problem	Likely Cause(s)	Resolution
Your transmitter has lost connection with your pump.	Your pump is out of range. There is RF interference from other devices.	<ol style="list-style-type: none"> <li data-bbox="618 122 1078 297">1 Move away from any equipment that can cause RF interference. For more information on RF interference, see <i>Radio Frequency (RF) communication, on page 4</i>. If your transmitter is still not communicating with your pump, proceed to step 2. <li data-bbox="618 308 1078 454">2 Make sure your pump and your transmitter are located on the same side of your body to minimize any RF interference. If your transmitter is still not communicating with your pump, call 24-Hour Technical Support for assistance.
<p>Note: An alarm or alert occurs and a message appears when your transmitter has lost connection with your pump for 30 minutes.</p>		

Storage

Store the transmitter, charger, and tester in a clean, dry location at room temperature. If the transmitter is not in use, you must charge the transmitter at least once every 60 days.

CAUTION: Do not store the transmitter on the charger. If the transmitter is left on the charger for more than 60 days, the battery will be permanently damaged.

Disposal

Do not dispose the transmitter in unsorted municipal waste stream. Discard the transmitter according to local regulations for battery disposal, or contact your healthcare professional for disposal information.

Specifications

Biocompatibility	Transmitter: Complies with EN ISO 10993-1
Applied parts	Transmitter Sensor

Operating conditions	<p>Transmitter temperature: 32°F to 113°F (0°C to 45°C)</p> <p>Caution: When operating the transmitter on a tester in air temperatures greater than 106°F (41°C), the temperature of the transmitter may exceed 109°F (43°C).</p> <p>Transmitter relative humidity: 10% to 95% with no condensation</p> <p>Transmitter pressure: 8.4 psi to 15.4 psi (57.60 kPa to 106.17 kPa)</p> <p>Charger temperature: 50°F to 104°F (10°C to 40°C)</p> <p>Charger relative humidity: 30% to 75% with no condensation</p>
Storage conditions	<p>Transmitter temperature: -4°F to 131°F (-20°C to 55°C)</p> <p>Transmitter relative humidity: up to 95% with no condensation</p> <p>Transmitter pressure: 8.4 psi to 15.4 psi (57.6 kPa to 106 kPa)</p> <p>Charger temperature: 14°F to 122°F (-10°C to 50°C)</p> <p>Charger relative humidity: 10% to 95% with no condensation</p>
Battery life	<p>Transmitter: Seven days of continuous glucose monitoring immediately following a full charge.</p> <p>Charger: The charger uses one new AAA battery to charge the transmitter.</p>
Transmitter frequency	2.4 GHz band, Bluetooth™* wireless technology (version 4.0)
Effective radiated power (ERP)	0.06 mW (-12.05 dBm)
Effective isotropic radiated power (EIRP)	0.1 mW (-9.9 dBm)
Operating range	Up to 6 feet (1.8 meters) in free-air
Transmitter expected service life	The transmitter expected service life is one year depending on patient usage.

Transmitter wireless communication

Quality of service

The transmitter and insulin pump connect via smart device connectivity. The transmitter sends glucose data and system-related alerts to the pump. The pump verifies the integrity of received data after wireless transmission.

Data security

The transmitter is designed to only accept radio frequency (RF) communications from recognized and linked devices. You must pair your pump with the transmitter before the pump will accept information from the transmitter.

The MiniMed™ insulin pumps and system components (meters and transmitters) ensure data security via proprietary means and data integrity using error checking processes, such as cyclic redundancy checks.

Traveling by air

Your transmitter is safe for use on commercial airlines. If questioned by airline personnel about the use of your device, please show them your Medical emergency card.

Guidance and manufacturer's declaration

Guidance and Manufacturer's Declaration - Electromagnetic Emissions		
Emissions Test	Compliance	Electromagnetic Environment - Guidance
RF emissions CISPR 11	CISPR 11 Group 1, Class B	<p>The transmitter uses RF energy only for system communications. Therefore, its RF emissions are very low and are not likely to cause any interference in nearby electronic equipment.</p> <p>Note: <i>The preceding statement is required by IEC 60601-1-2 for Group 1, Class B devices. Since the transmitter is battery powered, its emissions will not be affected by the establishment power supply and there is no evidence of any issues associated with the use of the system in domestic establishments.</i></p>
Harmonic emissions IEC 61000-3-2	Not applicable	
Voltage fluctuations/flicker emissions IEC 61000-3-3	Not applicable	

Guidance and Manufacturer's Declaration - Electromagnetic Immunity			
Immunity Test	IEC 60601-1-2:2014 Test Level	Max foreseeable use condition per IEC 60601-1-2:2014	Electromagnetic Environment Guidance
Electrostatic discharge (ESD) IEC 61000-4-2	±8 kV contact ±2 kV, ±4 kV, ±8 kV, ±15 kV air	±8 kV contact ±2 kV, ±4 kV, ±8 kV, ±15 kV air	For use in a typical domestic, commercial, or hospital environment.
Conducted disturbances induced by RF fields	3 Vrms 150 kHz to 80 MHz 6 Vrms ISM bands between 150 kHz to 80 MHz	Not applicable	Requirement does not apply to this battery powered device.
Electrical fast transient/burst IEC 61000-4-4	±2 kV 100 kHz repetition frequency	Not applicable	Requirement does not apply to this battery powered device.

Guidance and Manufacturer's Declaration - Electromagnetic Immunity			
Immunity Test	IEC 60601-1-2:2014 Test Level	Max foreseeable use condition per IEC 60601-1-2:2014	Electromagnetic Environment Guidance
Surge IEC 61000-4-5	Line to Line: ± 0.5 kV, ± 1 kV Line to Ground: ± 0.5 kV, ± 1 kV, ± 2 kV	Not applicable	Requirement does not apply to this battery powered device.
Note: U_T is the a.c. mains voltage prior to application of the test level.			
Voltage dips, short interruptions, and voltage variations on power supply lines IEC 61000-4-11	0% U_T ; 0.5 cycles (at 0°, 45°, 90°, 135°, 180°, 225°, 270°, and 315°) 0% U_T ; 1 cycle (at 0°) 70% for 25/30 cycles (at 0°) 0% for 250/300 cycles	Not applicable	Requirement does not apply to this battery powered device.
Power frequency (50/60 Hz) magnetic field IEC 61000-4-8	30 A/m	30 A/m	For use in a typical domestic, commercial, or hospital environment.
Proximity fields from RF wireless communications equipment IEC 61000-4-3	IEC 60601-1-2:2014, Table 9	IEC 60601-1-2:2014, Table 9	For use in a typical domestic, commercial, or hospital environment.
Note: U_T is the a.c. mains voltage prior to application of the test level.			

Guidance and Manufacturer's Declaration - Electromagnetic Immunity			
Immunity Test	IEC 60601-1-2:2014 Test Level	Max foreseeable use condition per IEC 60601-1-2:2014	Electromagnetic Environment Guidance
Radiated RF IEC 61000-4-3	10 V/m 80 MHz to 2.7 GHz 80% AM at 1 kHz	10 V/m 80 MHz to 6 GHz 80% AM at 1 kHz	Portable and mobile RF communications equipment should be used no closer to any part of the transmitter than the recommended separation distance of 12 in (30 cm). Field strengths from fixed RF transmitters, as determined by an electromagnetic site survey, should be less than the compliance level in each frequency range. Interference may occur in the vicinity of equipment marked with the following symbol: 
Note: <i>These guidelines may not apply in all situations. Electromagnetic propagation is affected by absorption, and reflection from structures, objects and people.</i>			

Warranty

Medtronic MiniMed, Inc. (or such other legal entity as may be referred to as manufacturer on the labeling of this device "Medtronic MiniMed") warrants the Medtronic transmitter to the purchaser of the product against defects in material and workmanship for a period of one (1) year and the charger for up to one (1) year from the date of purchase.

During the warranty period, Medtronic MiniMed will replace or repair, at its discretion, any defective transmitter or charger, subject to the conditions and exclusions stated herein. This warranty applies only to new devices. In the event a transmitter or charger is replaced, the warranty period will not be extended past its original expiration date.

This warranty is valid only if the Medtronic transmitter or charger is used in accordance with the manufacturer's instructions. Without limitation, this warranty will not apply:

- If damage results from changes or modifications made to the transmitter or charger by the user, or third persons, after the date of purchase.

- If damage results from service or repairs performed by any person or entity other than the manufacturer.
- If damage results from a *Force Majeure* or other event beyond the control of the manufacturer.
- If damage results from negligence or improper use, including but not limited to: improper storage, submersion in water, physical abuse, (such as dropping).
- If damage results from use of the device in a manner other than according to the manufacturer's product labeling, instructions for use, or regulatory notifications.

This warranty shall be personal to the original purchaser. Any sale, rental or other transfer or use of the product covered by this warranty to or by a user other than the original purchaser shall cause this warranty to immediately terminate. This warranty does not apply to Glucose Sensors and other accessories.

The remedies provided for in this warranty are the exclusive remedies available for any breach hereof. Neither Medtronic MiniMed nor its suppliers or distributors shall be liable for any incidental, consequential, or special damage of any nature or kind caused by or arising out of a defect in the product.

All other conditions and warranties, other than mandatory statutory warranties, expressed or implied, are excluded, including the warranties of merchantability and fitness for a particular purpose.

This warranty gives the purchaser specific legal rights, and the purchaser may also have other rights that vary under local law. This warranty does not affect the purchaser's statutory rights.

Open Source Software (OSS) disclosure

This document identifies the Open Source Software that may be separately called, executed, linked, affiliated, or otherwise utilized by this product.

Such Open Source Software is licensed to users subject to the terms and conditions of the separate software license agreement for such Open Source Software.

Use of the Open Source Software by you shall be governed entirely by the terms and conditions of such license.

The source/object code and applicable license for the Open Source Software can be obtained at the following site: <http://www.ouah.org/ogay/hmac/>.

Icon glossary

For definition of the symbols displayed on the device and package labels, please see www.medtronicdiabetes.com/symbol-definitions.

© 2020 Medtronic MiniMed, Inc. All rights reserved.

Medtronic, Medtronic logo and Further, Together are trademarks of Medtronic. ™* Third party brands are trademarks of their respective owners. All other brands are trademarks of a Medtronic company.

Bluetooth™*

Detachol™*

Wi-Fi™*

Medtronic



Medtronic MiniMed
18000 Devonshire Street
Northridge, CA 91325 USA
1800 646 4633
+1 818 576 5555
www.medtronicdiabetes.com

REF MMT-7911, MMT-7736L, MMT-7715,
MMT-7512

R_x Only

M998596A011_B