

CARELINK™ SOFTWARE QUICK REFERENCE GUIDE

MINIMED™ 700 SERIES INSULIN PUMP SYSTEMS

INSTALLING THE CARELINK™ UPLOADER

Patient: Go to <http://Carelink.Minimed.com>

Clinic: Go to <http://Carelink.Medtronic.com>

There are 2 ways to upload: The **preferred way** is to use the MiniMed™ Mobile app. Refer to the Quick Reference Guide for the MiniMed™ Mobile app.

This guide should be used with a MiniMed™ 700 series insulin pump that is uploading to CareLink™ software with a blue adapter, instead of using the MiniMed™ Mobile app.

If this is the first time using CareLink™ system and you do not have the uploader software on your computer, follow these steps. You should only have to do these steps once.

1 Select How to Install Uploader link to download the **CareLink™ Uploader Software** before uploading your device. Administrator rights are required.

2 Select Download CareLink™ Uploader Installer and follow the installation steps to complete the process.



UPLOAD THE MINIMED™ 700 SERIES INSULIN PUMP USING THE BLUE ADAPTER

Do not insert the blue adapter into your computer until the uploader software instructs you.

1 Select one.

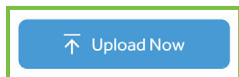

Patient: From the home screen select the blue button on the screen to upload device.



Clinic: Click your desired patient profile, select the blue button.

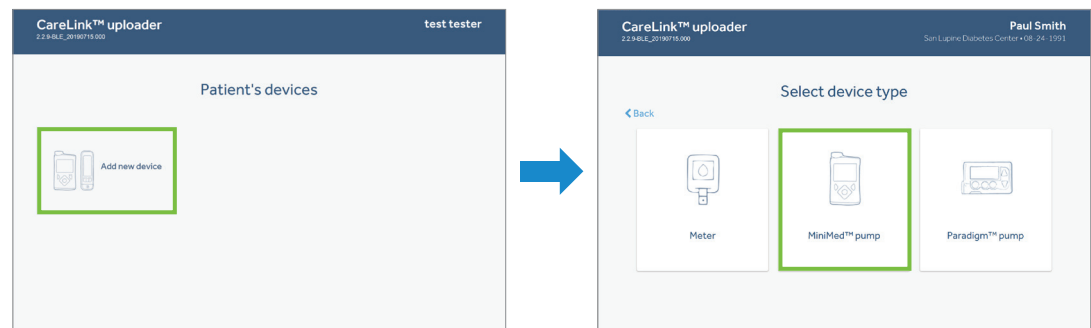

2 If this is the first time using CareLink™ software, you will need to **Add Devices**.

UPLOAD THE MINIMED™ 700 SERIES INSULIN PUMP USING THE BLUE ADAPTER

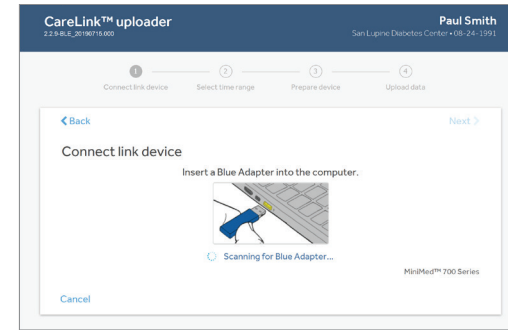
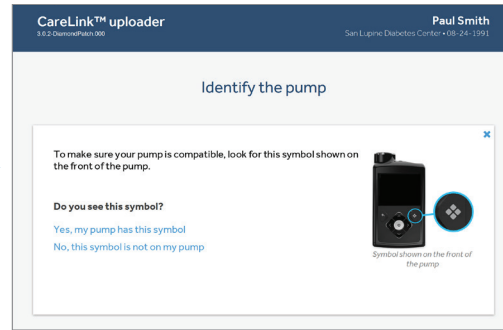
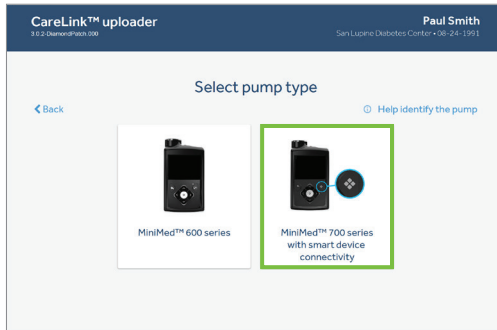

3 Select a pump to upload. You will be able to recognize the MiniMed™ 700 series pump system with smart device connectivity by looking at the symbol on the front of the pump.

4 Insert the blue adapter into the USB port on the computer.

By selecting the box that says **MiniMed™ 700 series with smart device connectivity**, the program will automatically begin to scan for the blue adapter.

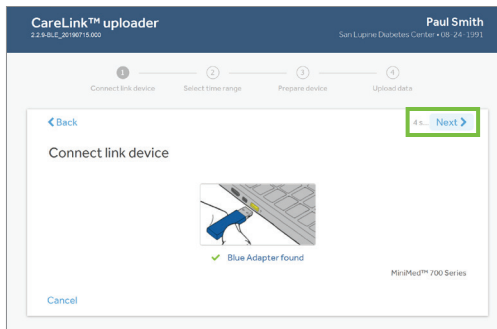

5 Once it's found you will receive the message **blue adapter found**. **Select Next to continue.**

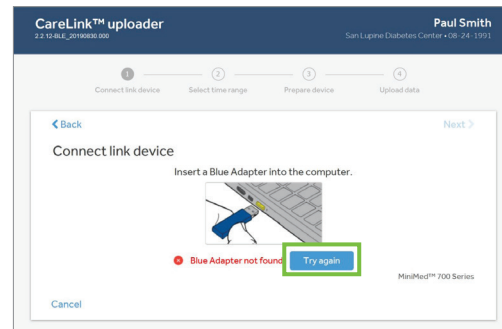

6 If the blue adapter is not inserted soon enough you may receive the message **blue adapter not found**.

Remove and reinsert blue adapter and select **Try Again**.

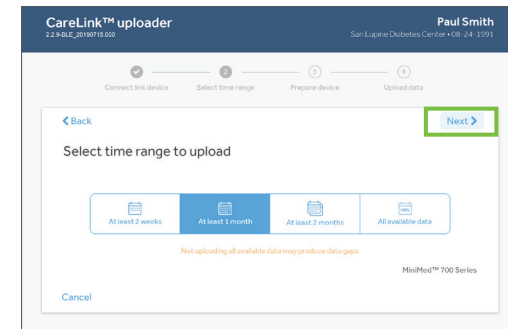

7 Select the desired time range to upload and then **Select Next**.

UPLOAD THE MINIMED™ 700 SERIES INSULIN PUMP USING THE BLUE ADAPTER

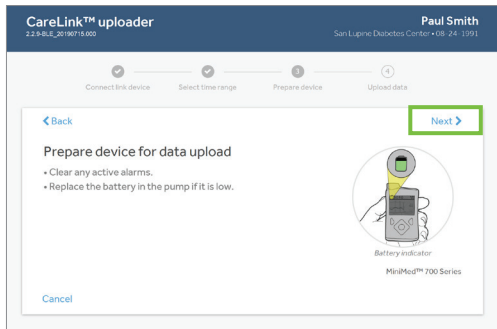

8 Prepare device for data upload. Clear any active alarms and replace the battery in the pump if it is low. **Select Next.**

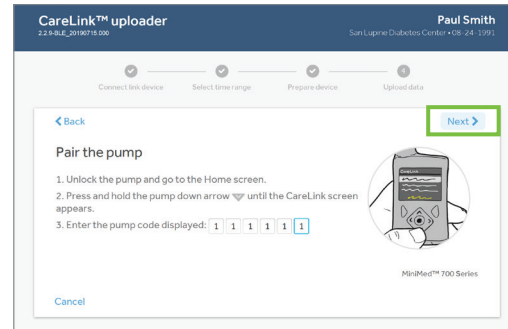

9 Pair the pump. At the pump home screen, press and hold the down arrow key until CareLink™ menu appears. Enter the pump code displayed on pump into CareLink™ Uploader. **Select Next.**

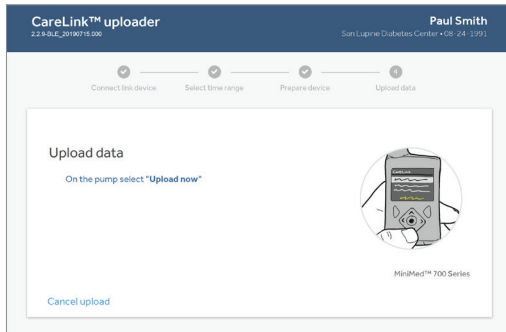
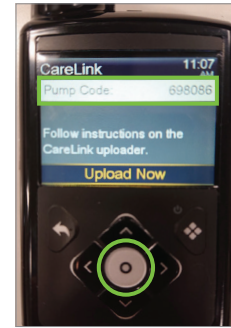

10 On the pump select **Upload Now**. This step must be completed for data to begin the upload process. Screen timeout on the pump will occur if **Upload Now** is not pressed within 2 minutes after accessing the menu.

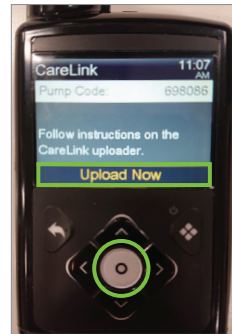

11 To confirm the data upload has started:

- 1 You will see a CareLink™ Uploader progress bar on the computer.
- 2 On the pump you will see a sync icon in the middle of the screen similar to a **spinning circle**.